

Interfaces

LOXONE Tree	connection with Miniserver / Tree Extension
Hörmann HCP	Compatible with Hörmann Communication Protocol 1 and 2 (HCP) The device recognizes automatically which garage door operator is connected and which HCP version is used.

An up-to-date List of compatible Hörmann operators is available online: shop.loxone.com/product/100592-hoermann-tree/

Ambient Conditions

Temperature	-20 ... 65 °C / -4 ... 149 °F
Humidity	max. 95 % RH (non-condensing)
Ingress Protection	IP20

24 V DC & LOXONE Tree Terminals

Wire cross-section	0.28 ... 0.8 mm ² / AWG 23 ... 18
Stripping length	5 ... 6 mm / 0.2 ... 0.24"
Temperature resistance	-40 ... 105 °C / -40 ... 221 °F

Connecting Cable

Wire cross-section	0.2 mm ² / AWG 24
Temperature resistance	80 °C / 176 °F
Length	100 mm / 3.94"
Connector	Modular 6P6C (RJ-12)
Part No.	000588



For more information about this product, visit loxone.com/help/hoermann-tree

Loxone Electronics GmbH
Smart Home 1
4154 Kollerschlag
Austria

Loxone US
3060 Plaza Drive
Suite 105
Garnet Valley, PA 19060
United States

Loxone UK
The Forum
Station Road
Theale, RG7 4RA
United Kingdom



For additional information, declaration of conformity, visit www.loxone.com/datasheets

Need Help?
loxone.com/support

V030626



Hörmann Tree

Part No.: 100592

LOXONE

About the product

Hörmann Tree is a wired interface for seamless integration of Hörmann garage door operators into the LOXONE system. Using LOXONE Tree and the Hörmann Communication Protocol (HCP), it enables reliable, bidirectional communication and real-time control.

Features

- Supports HCP1 and HCP2
- Automatic operator detection
- Bidirectional communication
- Status monitoring (state, cycles, operating hours)
- Simple commissioning via Plug & Play
- Full user interface and control in the LOXONE App

Electrical Specifications

Supply Voltage	10 ... 28 V DC
Power Consumption	typ. 0.06 W, max. 0.07 W

Safety Instructions

Installation must be carried out by a qualified electrician in accordance with the applicable regulations. This device is free of maintenance and must only be cleaned with a dry cloth.

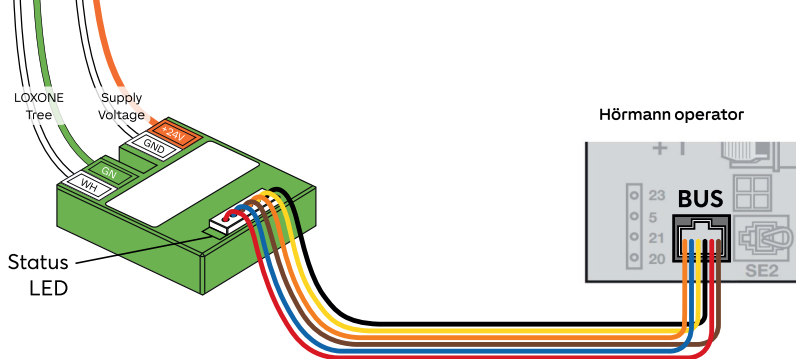

When using an operator with HCP2 interface, the BUS-Scan starts automatically after the operator restarts if Hörmann Tree is connected. When using an operator with HCP1 interface, the device is directly in pairing mode.

HCP2 operators → Start BUS-Scan

SupraMatic 4 / RollMatic 2:
Enter programming
Menu 37,
Parameter 01
activates BUS-Scan:

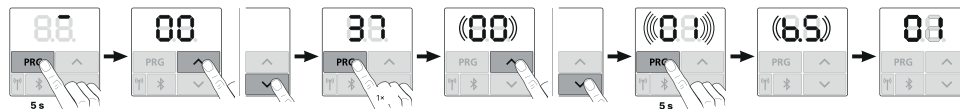

After activating the BUS-Scan, Hörmann Tree can be paired.

You can exit the menu by selecting parameter 00 and press PRG, or wait for 60 seconds.

ProMatic 4:
BUS-Scan at factory
Power-On or
set switch 8 to On
and Off again.

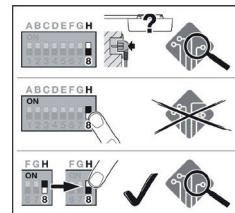

Liftronic 700 / 800-2:
BUS-Scan at factory
Power-On or
set switch 5 to On
and Off again.

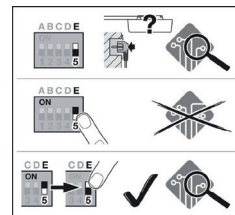

Note:
Liftronic 500-2 sets
switch 4

Hörmann 545 / 560:
Press the PRG button for 5 s
Enter code 9902 (reset / BUS
scan)
Press the Stop button for 5 s
→ BS (BUS search) appears
→ BS1 should be found

