

## Datasheet

### LED Strip Tunable White

### IP20 (touch-safe)

Part No: 200408



### About the product

The Tunable White LED strip is ideal for creating **different lighting scenes** in **cold white** and **warm white** light for **indirect lighting** in your building.

#### Features:

- 300 high-quality LEDs across 5m
- Adhesive strips on the underside for easy attachment
- High-quality and durable conductor tracks for increased kink resistance and to prevent heat build-up

### Technical Data

Power Supply	24VDC constant voltage, PWM dimmable
Power consumption	Total: 60W, 12W/m WW: 30W, 6W/m CW: 30W, 6W/m
Energy efficiency (EU) 2017/1369	G
Humidity	10 - 95% r.H. (non condensing)
Cutttable	Every 10cm / 3.94"
Max. LED strip length	10m / 393.7"

### Ambient Conditions

Temperature	-25 ... 50 °C / -13 ... 122 °F
-------------	--------------------------------

## Light Properties

Colour temperature	WW: 2900K (+/- 200K) CW: 6000K (+/- 200K)
Luminous flux	3600lm
Colour rendering index (CRI)	80+
Luminous Efficiency	60lm/W
Beam angle	120°

## Connections

Wire cross-section	Connection Cables: 0.5mm <sup>2</sup> / AWG22 Connector: 0.5 ... 1mm <sup>2</sup> / AWG22 ... AWG18
Temperature resistance	Connection Cables: max. 70°C / 158°F Connector: max. 70°C / 158°F
Length	Connection Cables: 130mm / 5.12" Connector: -
Connector type	Type of Connector: - Connector: Hippo-M
Wire colours	Black: Plus (+) Yellow: WW (-) White: CW (-)

## Connection Diagram

Connection Diagram

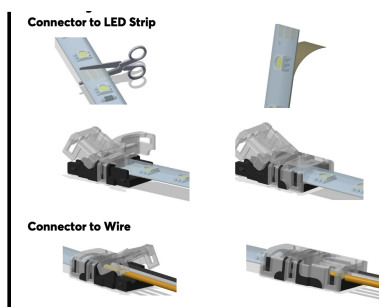

## Weight & Dimensions

Net weight	108 g
Total weight	146g
Product dimensions	5000x10x2mm / 196.85x0.39x0.08"
Product dimensions drawing	<p>The drawing shows a top view of a 5000mm long strip with a 16.67mm pitch between switches. The width is 10mm and the height is 2mm. A 8.33mm offset is shown from the left edge. Below are three side views for IP20, IP65, and IP68 ratings, showing mounting heights of 0.3mm, 0.3mm, and 5.3mm respectively.</p>
Pack size	142x142x25.5mm / 5.59x5.59x1" (LxWxH)

## Certifications & Standards

Safety class	IP20
Certifications	

Installation must be carried out by a qualified electrician in accordance with the relevant regulations.

### Published by

Loxone Electronics GmbH  
 Smart Home 1  
 4154 Kollerschlag  
 Austria  
 Tel: +43 7287 7070-0  
 loxone.com

Loxone UK Ltd.  
 The Forum  
 Station Road  
 Theale, RG7 4RA  
 United Kingdom

## Datenblatt

### LED Streifen Tunable White

### IP20 (berührungssicher)

Part No: 200408



## Über das Produkt

Der LED Streifen Tunable White eignet sich optimal zur Realisierung von **unterschiedlichen Lichtszenen** in **kaltweißen** und **warmweißen** Licht zur **Indirektbeleuchtung** in Ihrem Gebäude.

### Features:

- 300 qualitativ hochwertige LED Chips auf 5 Meter
- Klebestreifen an der Unterseite für eine einfache Befestigung
- Hochwertige und langlebige Leiterbahnen für erhöhte Knicksicherheit und zur Vermeidung von Wärmeentwicklung

## Technische Daten

Spannungsversorgung	24VDC Konstantspannung, PWM dimmbar
Leistungsaufnahme	Gesamt: 60W, 12W/m WW: 30W, 6W/m CW: 30W, 6W/m
Energieeffizienz (EU) 2017/1369	G
Luftfeuchtigkeit	10 - 95% r.H. (nicht kondensierend)
Kürzbar	Alle 10cm / 3,94"
Max. Länge LED Streifen	10m / 393.7"

## Umgebungsbedingungen

Temperatur	-25 ... 50 °C / -13 ... 122 °F
------------	--------------------------------

## Lichteigenschaften

Farbtemperatur	WW: 2900K (+/- 200K) CW: 6000K (+/- 200K)
Lichtstrom	3600lm
Farbwiedergabeindex (CRI)	80+
Lichtausbeute	60lm/W
Strahlwinkel	120°

## Anschlüsse

Leiterquerschnitt	Anschlussleitungen: 0,5mm <sup>2</sup> / AWG22 Verbinder: 0,5 ... 1mm <sup>2</sup> / AWG22 ... AWG18
Temperaturbeständigkeit	Anschlussleitungen: max. 70°C / 158°F Verbinder: max. 70°C / 158°F
Länge	Anschlussleitungen: 130mm / 5,12" Verbinder: -
Anschlussstyp	Anschlussleitungen: - Verbinder: Hippo-M
Aderfarben	Schwarz: Plus (+) Gelb: WW (-) Weiß: CW (-)

## Anschlussplan

Anschlussplan

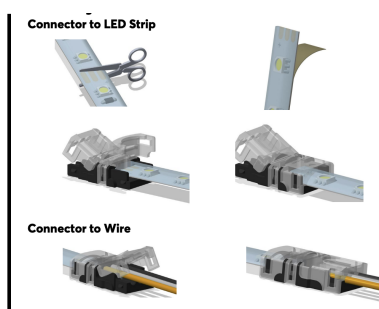

## Gewicht & Abmessungen

Nettogewicht	108 g
Bruttogewicht	146g
Produktmaße	5000x10x2mm / 196.85x0.39x0.08"
Produktmaßzeichnung	<p>The technical drawing shows a top view of the module with a total length of 5000 units and a pitch of 16.67 units between components. A component width of 8.33 units is also indicated. Below the top view, three side views are shown for different IP ratings: IP20 (height 2 units), IP65 (height 3 units), and IP68 (height 5.3 units). All side views show a width of 0.3 units.</p>
Packmaß	142x142x25.5mm / 5.59x5.59x1" (LxWxH)

## Zertifizierungen & Standards

Schutzklasse	IP20
Zertifizierungen	<p>The image shows two certification logos: the CE mark and the UKCA mark, both enclosed in rounded rectangular boxes.</p>

Die Installation muss von einer qualifizierten Elektrofachkraft gemäß den einschlägigen Vorschriften durchgeführt werden.

### Veröffentlicht von

Loxone Electronics GmbH  
 Smart Home 1  
 4154 Kollerschlag  
 Austria  
 Tel: +43 7287 7070-0  
 loxone.com

Loxone UK Ltd.  
 The Forum  
 Station Road  
 Theale, RG7 4RA  
 United Kingdom