

Datasheet

LED Strip Tunable White

IP65 (splashproof)

Part No: 200409

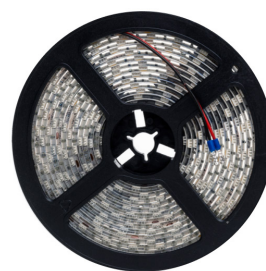

About the product

The Tunable White LED strip is ideal for creating **different lighting scenes** in **cold white** and **warm white** light for **indirect lighting** in your building.

Features:

- 300 high-quality LED chips on 5 meters
- Adhesive strips on the underside for easy attachment
- High-quality and durable conductor tracks for increased resistance to kinking and to prevent heat build-up
- Resistant and odorless coating for the continuous maintenance of the protection class

Technical Data

| | |
|----------------------------------|---|
| Power Supply | 24VDC constant voltage, PWM dimmable |
| Power consumption | Total: 60W, 12W/m WW: 30W, 6W/m CW: 30W, 6W/m |
| Energy efficiency (EU) 2017/1369 | G |
| Humidity | 10 - 95% r.H. (non condensing) |
| Cuttable | Every 10cm / 3.94" |
| Max. LED strip length | 10m / 393.7" |

Ambient Conditions

| | |
|-------------|--------------------------------|
| Temperature | -25 ... 50 °C / -13 ... 122 °F |
|-------------|--------------------------------|

Light Properties

| | |
|------------------------------|--|
| Colour temperature | WW: 2900K (+/- 200K) CW: 6000K (+/- 200K) |
| Luminous flux | 3600lm |
| Colour rendering index (CRI) | 80+ |
| Luminous Efficiency | 60lm/W |
| Beam angle | 120° |

Connections

| | |
|------------------------|--|
| Wire cross-section | Connection Cables: 0.5mm ² / AWG22 Connector: 0.5 ... 1mm ² / AWG22 ... AWG18 |
| Temperature resistance | Connection Cables: max. 70°C / 158°F Connector: max. 70°C / 158°F |
| Length | Connection Cables: 130mm / 5.12" Connector: - |
| Connector type | Type of Connector: - Connector: Hippo-M |
| Wire colours | Black: Plus (+) Yellow: WW (-) White: CW (-) |

Connection Diagram

Connection Diagram

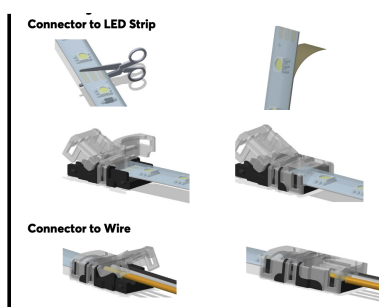

Weight & Dimensions

| | |
|----------------------------|--|
| Net weight | 220g |
| Total weight | 261g |
| Product dimensions | 5000x10x3mm - 196.85x0.39x0.12" |
| Product dimensions drawing | <p>The drawing shows a top view of a 5000mm long strip with a 16.67mm pitch between modules. A single module is 8.33mm wide. The height is 10mm. Below are three side views for IP20, IP65, and IP68 ratings. IP20 has a 0.3mm gap and 2mm height. IP65 has a 0.3mm gap, 2mm height, and a 3mm protrusion. IP68 has a 0.3mm gap, 2mm height, and a 5.3mm protrusion.</p> |
| Pack size | 160x160x25.5mm / 6.30x6.30x1" (LxWxH) |

Certifications & Standards

| | |
|----------------------------------|---|
| specification_name.safety_rating | IP65 |
| Certifications | <p>The image shows the CE mark and the UKCA mark, indicating compliance with European and UK standards.</p> |

Installation must be carried out by a qualified electrician in accordance with the relevant regulations.

Published by

Loxone Electronics GmbH
 Smart Home 1
 4154 Kollerschlag
 Austria
 Tel: +43 7287 7070-0
 loxone.com

Loxone UK Ltd.
 The Forum
 Station Road
 Theale, RG7 4RA
 United Kingdom

Datenblatt

LED Streifen Tunable White

IP65 (spritzwasserfest)

Part No: 200409



Über das Produkt

Der LED Streifen Tunable White eignet sich optimal zur Realisierung von **unterschiedlichen Lichtszenen** in **kaltweißen** und **warmweißen** Licht zur **Indirektbeleuchtung** in Ihrem Gebäude.

Features:

- 300 qualitativ hochwertige LED Chips auf 5 Meter
- Klebestreifen an der Unterseite für eine einfache Befestigung
- Hochwertige und langlebige Leiterbahnen für erhöhte Knicksicherheit und zur Vermeidung von Wärmeentwicklung
- Beständige und geruchsneutrale Beschichtung für den fortlaufenden Erhalt der Schutzklasse

Technische Daten

| | |
|---------------------------------|--|
| Spannungsversorgung | 24VDC Konstantspannung, PWM dimmbar |
| Leistungsaufnahme | Gesamt: 60W, 12W/m WW: 30W, 6W/m CW: 30W, 6W/m |
| Energieeffizienz (EU) 2017/1369 | G |
| Luftfeuchtigkeit | 10 - 95% r.H. (nicht kondensierend) |
| Kürzbar | Alle 10cm / 3,94" |
| Max. Länge LED Streifen | 10m / 393.7" |

Umgebungsbedingungen

| | |
|------------|--------------------------------|
| Temperatur | -25 ... 50 °C / -13 ... 122 °F |
|------------|--------------------------------|

Lichteigenschaften

| | |
|---------------------------|--|
| Farbtemperatur | WW: 2900K (+/- 200K) CW: 6000K (+/- 200K) |
| Lichtstrom | 3600lm |
| Farbwiedergabeindex (CRI) | 80+ |
| Lichtausbeute | 60lm/W |
| Strahlwinkel | 120° |

Anschlüsse

| | |
|-------------------------|---|
| Leiterquerschnitt | Anschlussleitungen: 0,5mm ² / AWG22 Verbinder: 0,5 ... 1mm ² / AWG22 ... AWG18 |
| Temperaturbeständigkeit | Anschlussleitungen: max. 70°C / 158°F Verbinder: max. 70°C / 158°F |
| Länge | Anschlussleitungen: 130mm / 5,12" Verbinder: - |
| Anschlussstyp | Anschlussleitungen: - Verbinder: Hippo-M |
| Aderfarben | Schwarz: Plus (+) Gelb: WW (-) Weiß: CW (-) |

Anschlussplan

Anschlussplan

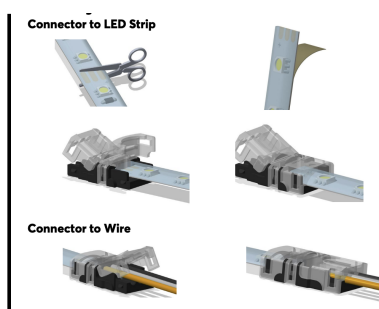

Gewicht & Abmessungen

| | |
|---------------------|---|
| Nettogewicht | 220g |
| Bruttogewicht | 261g |
| Produktmaße | 5000x10x3mm - 196.85x0.39x0.12" |
| Produktmaßzeichnung | <p>The technical drawing shows a top view of the device with a total length of 5000mm. The distance between the centers of two adjacent modules is 16.67mm. The width of the device is 10mm. The distance from the left edge to the center of the first module is 8.33mm. Below the top view, three side views are shown for different IP ratings: IP20, IP65, and IP68. The IP20 view shows a height of 2mm. The IP65 view shows a height of 3mm. The IP68 view shows a height of 5.3mm. All side views show a width of 2mm.</p> |
| Packmaß | 160x160x25.5mm / 6.30x6.30x1" (LxWxH) |

Zertifizierungen & Standards

| | |
|----------------------------------|--|
| specification_name.safety_rating | IP65 |
| Zertifizierungen | <p>The image shows two certification logos: the CE mark and the UKCA mark.</p> |

Die Installation muss von einer qualifizierten Elektrofachkraft gemäß den einschlägigen Vorschriften durchgeführt werden.

Veröffentlicht von

Loxone Electronics GmbH
 Smart Home 1
 4154 Kollerschlag
 Austria
 Tel: +43 7287 7070-0
 loxone.com

Loxone UK Ltd.
 The Forum
 Station Road
 Theale, RG7 4RA
 United Kingdom