

Datasheet

LED Strip Tunable White

IP68 (waterproof)

Part No: 200410



About the product

The Tunable White LED strip is ideal for creating **different lighting scenes** in **cold white** and **warm white** light for **indirect lighting** in your building.

Features:

- 300 high-quality LED chips on 5 meters
- Adhesive strips on the underside for easy attachment
- High-quality and durable conductor tracks for increased resistance to kinking and to prevent heat build-up
- Resistant and odorless coating for the continuous maintenance of the protection class

Technical Data

Power Supply	24VDC constant voltage, PWM dimmable
Power consumption	Total: 60W, 12W/m WW: 30W, 6W/m CW: 30W, 6W/m
Energy efficiency (EU) 2017/1369	G
Humidity	10 - 95% r.H. (non condensing)
Cuttable	Every 10cm / 3.94"
Max. LED strip length	10m / 393.7"

Ambient Conditions

Temperature	-25 ... 50 °C / -13 ... 122 °F
-------------	--------------------------------

Light Properties

Colour temperature	WW: 2900K (+/- 200K) CW: 6000K (+/- 200K)
Luminous flux	3600lm
Colour rendering index (CRI)	80+
Luminous Efficiency	60lm/W
Beam angle	120°

Connections

Wire cross-section	Connection Cables: 0.5mm ² / AWG22 Connector: 0.5 ... 1mm ² / AWG22 ... AWG18
Temperature resistance	Connection Cables: max. 70°C / 158°F Connector: max. 70°C / 158°F
Length	Connection Cables: 130mm / 5.12" Connector: -
Connector type	Type of Connector: - Connector: Hippo-M
Wire colours	Black: Plus (+) Yellow: WW (-) White: CW (-)

Connection Diagram

Connection Diagram

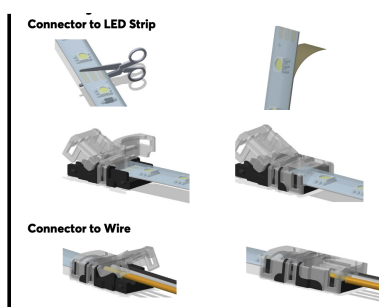

Weight & Dimensions

Net weight	370g
Total weight	423 g
Product dimensions	5000x12x5.3mm - 196.85x0.47x0.21"
Product dimensions drawing	<p>The drawing shows a top view of the device with a total length of 5000mm and a width of 12mm. The distance between the centers of the first and last components is 1667mm. The distance from the left edge to the first component is 8.33mm. The height of the device is 5.3mm. Below the top view, three side views are shown for different IP ratings: IP20 (height 2mm), IP65 (height 3mm), and IP68 (height 5.3mm). Each side view shows a mounting hole with a diameter of 0.3mm and a distance of 2mm from the edge to the hole.</p>
Pack size	200x200x25.5mm / 7.87x7.87x1" (LxWxH)

Certifications & Standards

specification_name.safety_rating	IP68
Certifications	<p>The image shows two certification logos: the CE mark and the UKCA mark, both enclosed in rounded rectangular boxes.</p>

Installation must be carried out by a qualified electrician in accordance with the relevant regulations.

Published by

Loxone Electronics GmbH
 Smart Home 1
 4154 Kollerschlag
 Austria
 Tel: +43 7287 7070-0
 loxone.com

Loxone UK Ltd.
 The Forum
 Station Road
 Theale, RG7 4RA
 United Kingdom

Datenblatt

LED Streifen Tunable White IP68 (wasserfest)

Part No: 200410



Über das Produkt

Der LED Streifen Tunable White eignet sich optimal zur Realisierung von **unterschiedlichen Lichtszenen** in **kaltweißen** und **warmweißen** Licht zur **Indirektbeleuchtung** in Ihrem Gebäude.

Features:

- 300 qualitativ hochwertige LED Chips auf 5 Meter
- Klebestreifen an der Unterseite für eine einfache Befestigung
- Hochwertige und langlebige Leiterbahnen für erhöhte Knicksicherheit und zur Vermeidung von Wärmeentwicklung
- Beständige und geruchsneutrale Beschichtung für den fortlaufenden Erhalt der Schutzklasse

Technische Daten

Spannungsversorgung	24VDC Konstantspannung, PWM dimmbar
Leistungsaufnahme	Gesamt: 60W, 12W/m WW: 30W, 6W/m CW: 30W, 6W/m
Energieeffizienz (EU) 2017/1369	G
Luftfeuchtigkeit	10 - 95% r.H. (nicht kondensierend)
Kürzbar	Alle 10cm / 3,94"
Max. Länge LED Streifen	10m / 393.7"

Umgebungsbedingungen

Temperatur	-25 ... 50 °C / -13 ... 122 °F
------------	--------------------------------

Lichteigenschaften

Farbtemperatur	WW: 2900K (+/- 200K) CW: 6000K (+/- 200K)
Lichtstrom	3600lm
Farbwiedergabeindex (CRI)	80+
Lichtausbeute	60lm/W
Strahlwinkel	120°

Anschlüsse

Leiterquerschnitt	Anschlussleitungen: 0,5mm ² / AWG22 Verbinder: 0,5 ... 1mm ² / AWG22 ... AWG18
Temperaturbeständigkeit	Anschlussleitungen: max. 70°C / 158°F Verbinder: max. 70°C / 158°F
Länge	Anschlussleitungen: 130mm / 5,12" Verbinder: -
Anschlussstyp	Anschlussleitungen: - Verbinder: Hippo-M
Aderfarben	Schwarz: Plus (+) Gelb: WW (-) Weiß: CW (-)

Anschlussplan

Anschlussplan

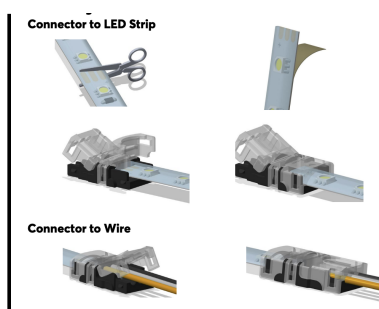

Gewicht & Abmessungen

Nettogewicht	370g
Bruttogewicht	423 g
Produktmaße	5000x12x5.3mm - 196.85x0.47x0.21"
Produktmaßzeichnung	<p>The technical drawing shows a top view of the device with a total length of 5000mm. The distance between the centers of two adjacent modules is 16.67mm. The width of the device is 10mm. The distance from the left edge to the center of the first module is 8.33mm. Below the top view, three side views are shown for different IP ratings: IP20, IP65, and IP68. The IP20 view shows a height of 2mm. The IP65 view shows a height of 3mm. The IP68 view shows a height of 5.3mm. All side views show a width of 2mm.</p>
Packmaß	200x200x25.5mm / 7.87x7.87x1" (LxWxH)

Zertifizierungen & Standards

specification_name.safety_rating	IP68
Zertifizierungen	<p>The image shows two certification logos: the CE mark and the UKCA mark.</p>

Die Installation muss von einer qualifizierten Elektrofachkraft gemäß den einschlägigen Vorschriften durchgeführt werden.

Veröffentlicht von

Loxone Electronics GmbH
 Smart Home 1
 4154 Kollerschlag
 Austria
 Tel: +43 7287 7070-0
 loxone.com

Loxone UK Ltd.
 The Forum
 Station Road
 Theale, RG7 4RA
 United Kingdom